

Model 310+311

Universal Carrier with Slide Out Ramp

Installation Guide & Owners Manual

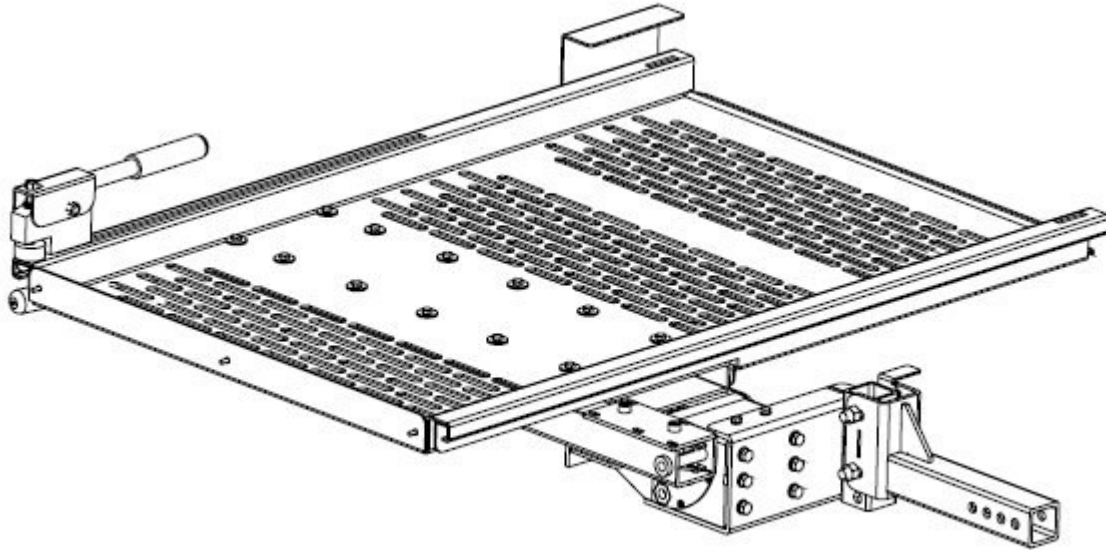

Congratulations on your new *WheelChair Carrier* product purchase. The Model 310+311 Universal Carrier with Slide Out Ramp is one of the easiest ways to transport your scooter or mid-wheel drive power chair. This manual has been written to be used as an installation guide as well as an operation guide for the end user.

Both installers and operators should read this manual thoroughly before attempting any installation, operation or maintenance of the Model 310+311 Universal Carrier with Slide Out Ramp.

If you have any questions or comments concerning the installation or operation of this carrier, please contact your local dealer or *WheelChair Carrier* for additional technical information. **Only authorized dealers should install this carrier.**

Manual Sections

- I. Unpacking the Carrier
- II. Preparing the Vehicle
- III. Installing the Carrier
- IV. Operating the Carrier
- V. Maintenance & Safety
- VI. Optional Accessories
- VII. Warranty & Return Policy

Section I. Unpacking the Carrier

You should receive two boxes containing the installation components for the Model 310+311 Universal Carrier with Slide Out Ramp

Box #1 Contents should include:

Carrier Base Unit
Carrier Platform
Hitch Attachment
Ratchet Straps (Set of 3)
Owners Manual

1/2-13 x 3 1/2" Hex Head Bolts (3 Required)
1/2-13 Hex Lock Nuts (3 Required)
1/4-20 x 1/2" Hex Head Bolts (14 Required)
1" OD Washers (14 Required)
Warranty Card

Box #2 Contents should include:

Slide Out Ramp
Brake
Handle

1/4-20 x 1/2" Hex Head Bolts (2 Required)
1/4" Lock Washers (2 Required)
10-32 x 1/2" Flat Head Machine Screws (3 Required)
10-32 Hex Nuts with Lock Washers (3 Required)

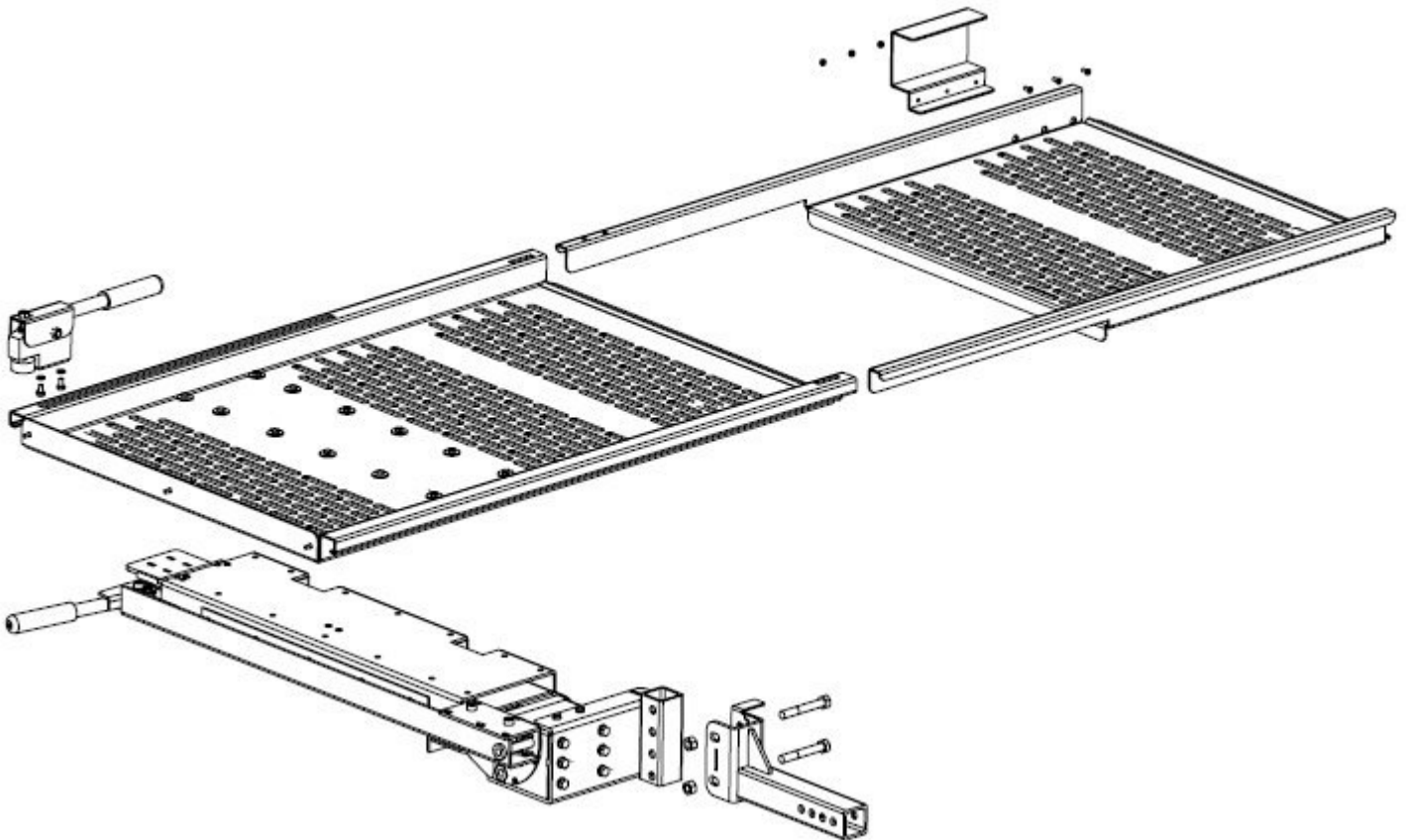

The Model 310+311 Universal Carrier with Slide Out Ramp is packaged to be used with a standard class 2 or class 3 hitch.

Be sure to check the contents of each box to make sure that all items listed above are included. If any parts that are required for proper installation of the carrier are missing or damaged, contact the dealer from which you purchased the carrier immediately.

DO NOT attempt to install or operate the carrier if there are any missing or damaged parts.

Section II. Preparing the Vehicle

In order to install the Model 310+311 Universal Carrier with Slide Out Ramp, the vehicle must be capable of accepting a standard class 2 or class 3 hitch. If you need assistance in choosing the correct hitch for your vehicle, contact your local hitch dealer such as U-Haul™. There are also many web sites on the internet that offer complete hitch guides and hitch search engines using your specific vehicle information. Below are a few sites that may be helpful:

<http://www.uhaul.com/>
<http://www.hitchfinder.com/>
<http://www.draw-tite.com/>
<http://www.reeseprod.com/>

Important: Every hitch bears a different amount of tongue weight. **NEVER** exceed the tongue weight capacity of your hitch.

Tongue Weight Calculation:

The Weight of the carrier

+

The Load (chair or scooter, any accessories such as the sliding ramp, detachable ramp, etc)

=

Tongue Weight

Weight Guide:

Model Number	Product Name	Weight LBS
310	Universal Carrier	69 *
311	Slide Out Ramp	13
312	Detachabale Ramp	9
321	Stop Plate	2
166	Cover	5
412	Class 2 Attachment	7
411	Class 3 Attachment	7
414	Height Adapter	7
130	Swing Away Option	40
333	Ratchet Straps	3

* Weight Shown Includes Hitch Attachment & Ratchet Straps

Important Notes:

- The Weight Capacity of the Model 310+311 Universal Carrier with Slide Out Ramp is 225 LBS
- Some vehicles will require the rear suspension be supplemented by the addition of air adjustable shocks or other devices to keep the vehicle level.
- The hitch should be installed by a reputable hitch dealer
- Due to the additional weight on the rear of your vehicle, your vehicle may handle differently. Avoid driving your vehicle during inclement weather conditions until you are familiar with any handling changes to your vehicle. Always take extra care when driving your vehicle.

Section III. Installing the Carrier

Tools Needed:

7/16" Hex Socket (1 Required)

3/4" Wrenches (2 Required)

5/16" Wrench (1 Required)

Philips Screwdriver (1 Required)

Model 310+311 Universal Carrier with Slide Out Ramp – Full Assembly View

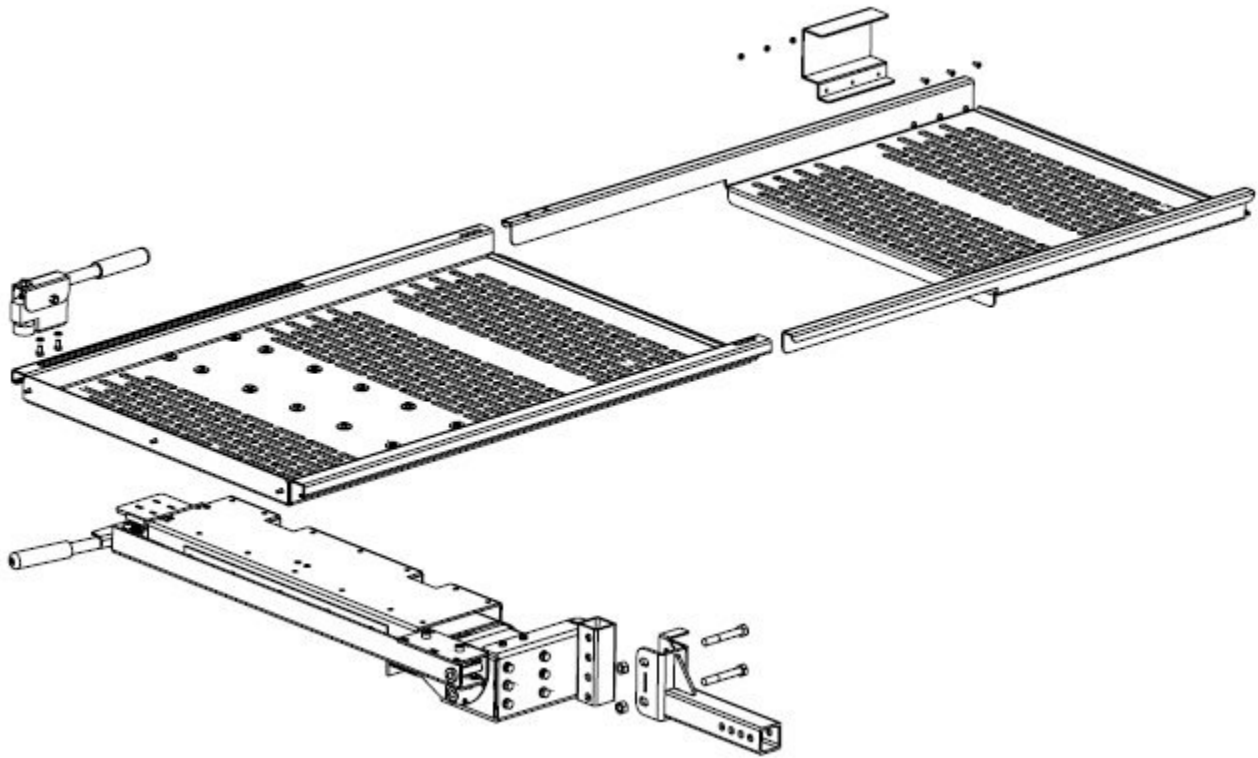

Installation Instructions:

The Model 310+311 Universal Carrier with Slide Out Ramp comes with one hitch attachment for either a class 2 or class 3 hitch. (The class of hitch should have been specified at the time of order) Make sure the attachment included is for the correct class of hitch.

Attach the hitch attachment to the base of the carrier (**figure 1**) using the 1/2-13 x 3 1/2" hex head bolts and the 1/2-13 hex lock nuts.

Use one of the 3/4" wrenches to hold the first hex head bolt, while using the other 3/4" wrench to tighten the matching hex lock nut. Following the above, tighten the second hex lock nut and bolt.

Note: Make sure lock nuts are as tight as possible

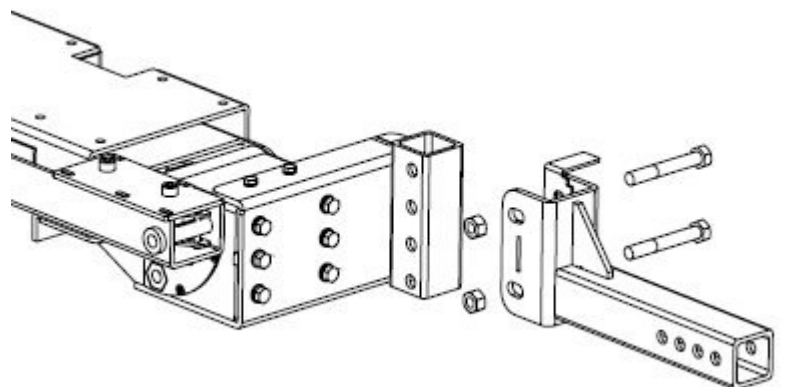

figure 1

Section III. Installing the Carrier (Continued)

Attach the assembled carrier base/hitch attachment to the hitch of the vehicle making sure that the base unit is parallel to the ground. Use the remaining 1/2-13 x 3 1/2" hex head bolt and 1/2-13 hex head lock nut to secure the unit in the hitch receiver.

Attach the platform to the carrier base/hitch attachment assembly using the 1/4-20 x 1/2" hex head bolts and the 1" OD washers. Make sure the holes of the platform are aligned with the threaded holes of the base (**figure 2**)

Make sure that the platform is parallel to the ground

Using the 7/16" hex socket, tighten all the bolts as much as possible.

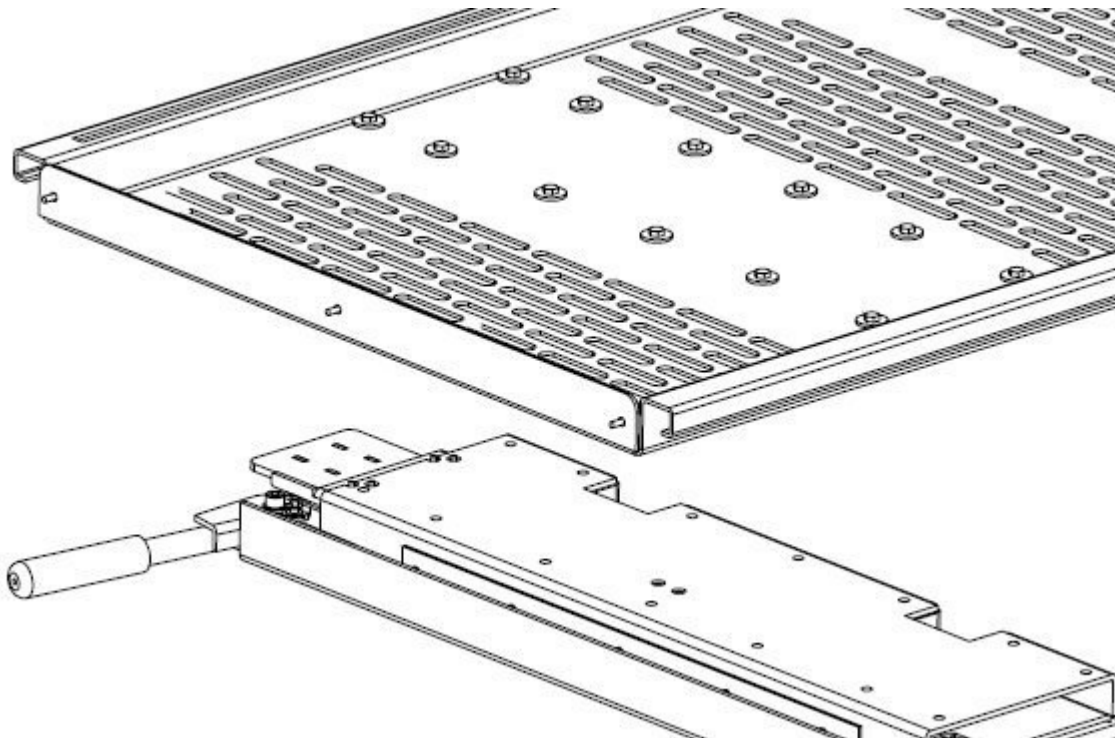

figure 2

Attach the handle to the slide out ramp (**figure 3**) using the 10-32 x 1/2" flat head machine screws and the 10-32 hex nuts with lock washers.

Use the Philips screwdriver to hold the first flat head machine screw, while using the 5/16" wrench to tighten the matching hex nut with lock washer. Following the above, tighten the second & third hex nuts with lock washers and flat head machine screws.

Note: Make sure hex nuts with lock washers are as tight as possible

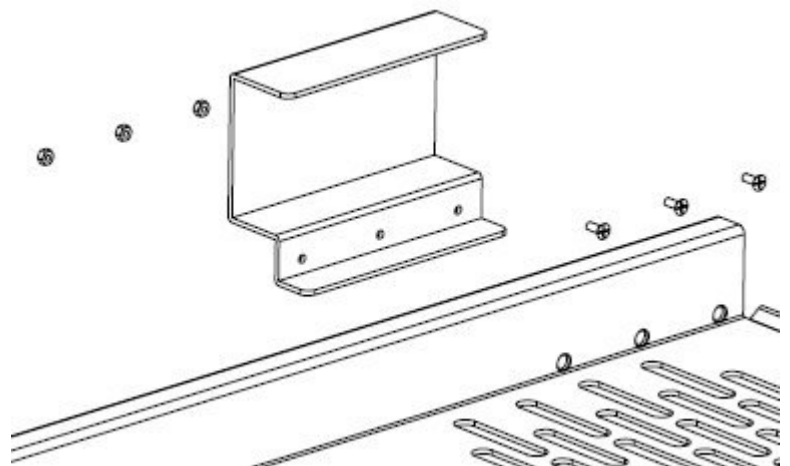

figure 3